

# swarna

Plot. No. 39, Vithalnagar CHS, 11th Road, JVPD Scheme, Near JVPD Gymkhana, Mumbai

PRECIOUS GIFT, FOR YOUR OWN FAMILY



Founded in Mumbai in 1964, P. R. Builders is among the premier house-builders in the city of Mumbai. The company has developed a number of projects in prime localities ranging from South Mumbai to Virar with several projects in the areas of Bandra, Khar and Santacruz. All our projects have also been successfully completed on schedule.



At P. R. Builders, we have consciously decided to present premium residential apartments. Our biggest strength is our experience, knowledge and a personal involvement in all aspects of home building.

We are committed to constant innovation and continuous product development, coupled with the highest standards of design, quality, construction and customer service.



P. R. Builders has made your decision simpler by giving you Swarna...

Quiet, casual, secure, convenient... That's Swarna for you! Located very conveniently in the middle of a residential area in JVPD Scheme, Swarna is just a stone's throw from schools, JVPD Gymkhana, shopping areas, cinema houses, etc. It is also in very close proximity to Mumbai's Juhu Beach (5 minutes drive) and several 5-star hotels. Welcome to a quiet, understated address virtually within range of bustling Mumbai and yet a wary distance from the din! Come home to your welcoming address... one that reflects your character and style!



A very practical floor plan of 3 BHK (with an opportunity to convert to 4), one apartment on each floor, gives way to well thought out, spacious rooms, common areas and public areas - all making the best use of available space. All this ensures that each apartment enjoys the best possible views and an abundance of natural light as well!



Its time to gift your family 'Swarna'!



## FEATURES

- 3 / 4 BHK apartments
- Stilt and Car Jack parking
- Easy access to railway stations, schools, hotels, cinemas, banks and markets
- Peaceful, quiet neighbourhood in JVPD

## GENERAL AMENITIES

- Modern, high-speed, automatic OTIS lift
- Decorative staircase & landing on each floor
- Best possible waterproofing

- Decorative entrance lobby with reception desk & waiting area for guests
- Servants toilet at each mid-landing

## APARTMENT AMENITIES

- Videophone security system
- Living room flooring in Italian marble
- Bedroom flooring in Italian marble
- Designer bathrooms with Jaquar fittings
- Storage boilers in all bathrooms
- Concealed plumbing
- Adequate electrical points including T.V. & telephone points in all

bedrooms and living room

- POP finish on walls & ceiling with POP cornices in living room & bedrooms
- Bronze anodized aluminium windows with tinted glass
- Modern kitchen with granite platform and S.S. sink of reputed brand
- Ceiling fans in all bedrooms, living room and kitchen
- Exhaust fan in all bathrooms
- Paving in entire compound
- Spacious lift lobby

Typical Floor Plan

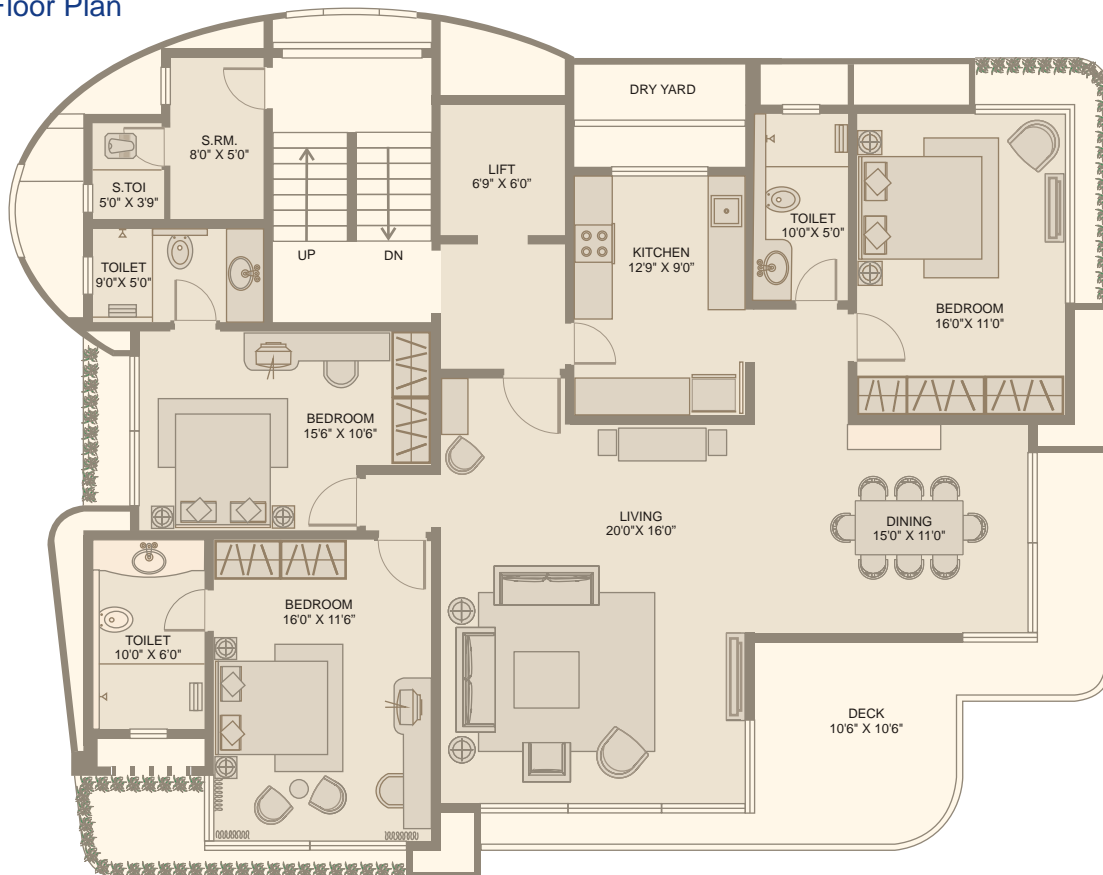

The information in this brochure is indicative of the development that is proposed. The developers reserve the right to change or alter the layout, plans, specifications or features without prior notice or obligation.

Site Address:  
Plot. No. 39, Vithalnagar CHS, 11th Road, JVPD Scheme,  
Near JVPD Gymkhana, Mumbai

LOCATION MAP:



1, Ashiana, 87, Linking Rd., Santacruz (West), Mumbai - 400 054  
Tel.: 26000534 / 35, 26460695, 56951038. Fax: 26460790  
Email: info@prbuilders.net